

API COUPLER - J0451



Quality and perfection always drive new standards within Emco Wheaton and this includes our API-coupler range that is used by petro-chemical companies worldwide.

The J0451 API Coupler has been the industry standard for over 30 years. It has recently been re-engineered to set a new, higher standard in API Couplings.

The J0451 is lightweight and maintenance friendly, allowing in-situ nose seal replacement. It includes a bevelled lip for ease of operation and provides better load distribution.

A number of improved components guarantee a safe, leak-free operation and easy, comfortable handling.

The J0451 API Coupler has superior sealing technology with three seal variants.

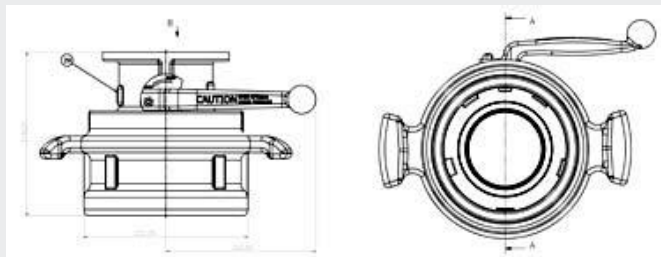

SPECIFICATIONS

- Quality forged aluminum lever
- Seal and gaskets contained in recessed cavity for tight seal
- Roller bearing in operator lever assures easy and smooth open/close action

- Pressure rating: 10 bar (150 PSI)
- Weight: 9.8 kg (21.61 lbs)
- Connects to 4" tank truck flange